

OREGON PUBLIC LAND CORNER REPORT / RESTORATION REPORT
Tillamook County Surveyor's Office

BOOK 8 207

SECTION: 29 and 30	TOWNSHIP: 1 South	RANGE: 10 West
COUNTY: Tillamook		DATE: 10/28/2024
CORNER DESIGNATION: The Quarter corner common to Sections 29 and 30, Township 1 South, Range 10 West; Willamette Meridian		(Please check one)
		<input type="checkbox"/> Condition Report Only
		<input type="checkbox"/> Restoration
		<input checked="" type="checkbox"/> Rewitness
		<input type="checkbox"/> Unrecorded
		<input type="checkbox"/> Reset at surface
		<input type="checkbox"/> Referenced Out

Previous Rewitnesses, Restorations and Surveys, etc... B-819 (1978), BLM field note volume OR-R0053 pg. 211

History, condition, and sources: BLM field not volume OR-R0053 pg. 211 set post for 1/4 corner and two accessories. In 1978 Robert Olsen found 1" iron pipe with babitt plug in good condition as reestablished by R.K. Miller. No record of the R.K. Miller evidence found by Robert Olsen in Tillamook County Records. See Map B-819. In 2024 Tillamook County Survey Office Found the 1" iron pipe with babitt plug stamped "1/4 30 29 #376" as shown hereon. The found record accessories are listed below.

- Found: (Map B-819, 1978) 36" hemlock S52°E 8.8' now badly rotted stump.
- Found: (Map B-819, 1978) 24" hemlock S52°W 7.0' now badly rotted stump.
- Not Found: (Map B-819, 1978) rotten hemlock stub S32°W 19.0'
- Found: (Map B-819, 1978) white painted cedar post Now found on ground alongside monument.
- Found: (unknow origin) metal T fence post North 0.30'

New accessories set:

The Monument was tied conventionally using double occupied GPS established control. The coordinates are provided here in WGS 84, latitude and longitude.

Latitude: 45°27'23.53611"
Longitude: -123°56'52.22704"

New Bearing trees:

- 6" hemlock N38°E 7.8' with yellow metal location tag scribed "XBT" with a nail and a washer between the B and the T.
- 4" hemlock south 3.35' with yellow metal location tag and scribed "XBT" with a nail and washer between the B and the T.

Pictures of Found Monuments:



Location: ±0.5 of a mile East behind a gated logging road. North ±300' from logging road in edge of Westerly tree line.

Tillamook County Surveyor office: 1510 3rd Street Suite C, Tillamook, OR. 97141

Party Chief: Travis Porter, Tillamook County Survey Office

Witnesses: Michael Rice P.L.S. 86926, Tillamook County Surveyor
Kael Poklikuha, Tillamook County Survey Tech

Notes: Digital images taken of monument and accessories.

SURVEYOR'S SEAL

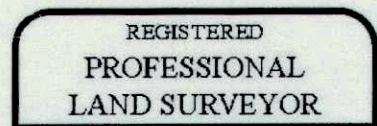

Michael R. Rice

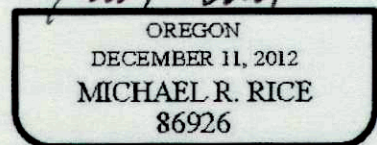

RENEWAL 12-31-2024

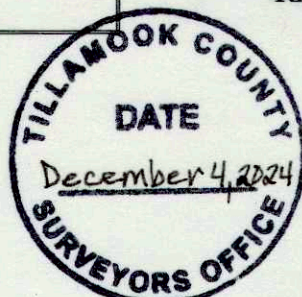

BOOK 8 207